

# Tru-Grip™ Clamps

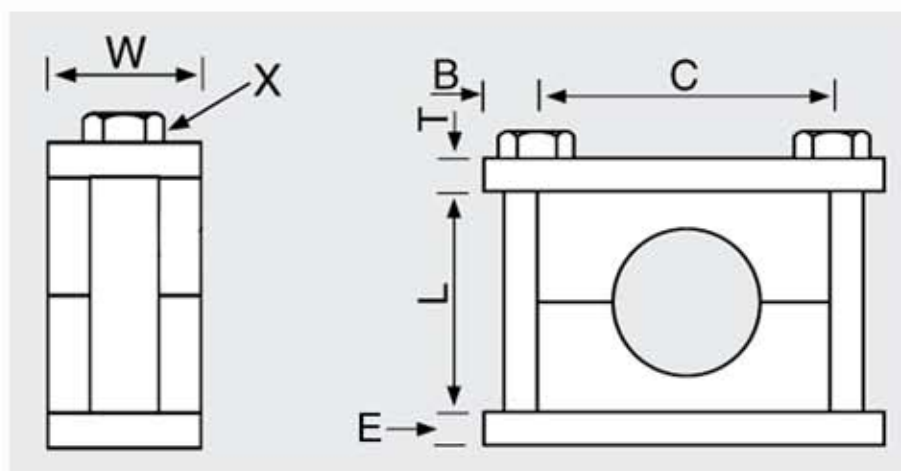

## Pipe & Clamp Size Configuration Information

Pipe Size	Clamp Number	DIMENSIONS IN INCHES						
		B	C	E	L	T	W	X
.5"	TG-107-SB-1-R-1/2 P	.375	2.000	.312	1.850	.187	1.000	$\frac{5}{16}$ - 18
.75"	TG-107-SB-1-R-3/4 P	.375	2.000	.312	1.850	.187	1.000	$\frac{5}{16}$ - 18
1"	TG-107-SB-1-R-1 P	.375	2.000	.312	1.850	.187	1.000	$\frac{5}{16}$ - 18
1.25"	TG-115-SB-1-R-1-1/4 P	.500	2.500	.375	2.125	.250	1.250	$\frac{7}{16}$ - 14
1.5"	TG-120-SB-1-R-1-1/2 P	.500	3.000	.375	2.625	.250	1.250	$\frac{7}{16}$ - 14
2"	TG-125-SB-1-R-2 P	.500	3.500	.375	3.125	.250	1.250	$\frac{7}{16}$ - 14
2.5"	TG-30-SB-1-R-2-1/2 P	.625	4.250	.500	3.600	.375	1.750	$\frac{1}{2}$ - 13
3"	TG-35-SB-1-R-3 P	.625	4.750	.500	4.000	.375	1.750	$\frac{1}{2}$ - 13
4"	TG-45-SB-1-R-4 P	.625	5.750	.500	5.000	.375	1.750	$\frac{1}{2}$ - 13

Stock clamp sizes also available for tube and hose.

**Custom designs and configurations available.**

*Call us today for pricing!*





# Tru-Grip™ Clamps

## Common Configurations Available in Welded or Channel Mount

Available in POLY or Aluminum body.

Single  
Welded



Single  
Channel  
Mount



Double  
Welded



Double  
Stack  
Welded



Custom

